

Bristol®

Q-IV Swing n' Slide

- **Cleaning**

- **Operating**

- **Maintaining**

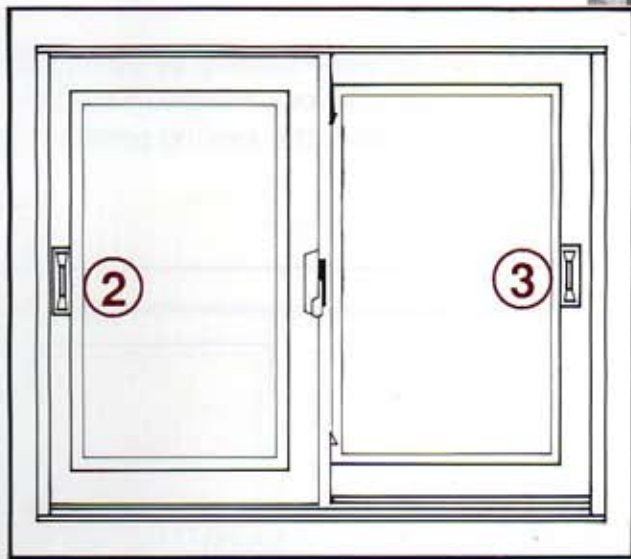
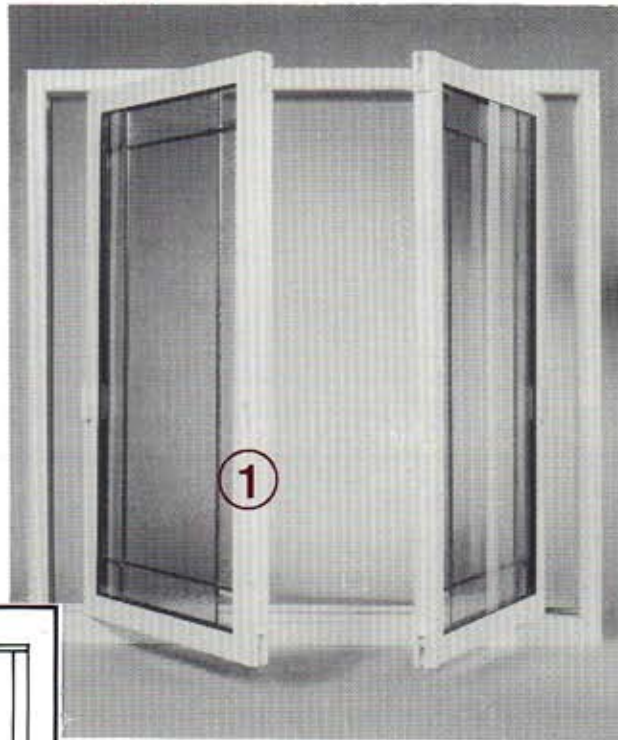

- 1) Unlock Q-IV security lock by putting lever in upper most position, ①.
- 2) Slide both sash approximately 3 to 4 inches, enough to clear jambs, toward center of window, using sash handles, ② and ③.

- 3) To disengage swing n' slide release latches on the inner most sash: Pull thumb release on top lock, ④, **down** to release locking bar and push bar up into header to a horizontal position, ⑤,

Push thumb release on bottom lock, ⑥, **up** to release locking bar and push bar down into sill, ⑦, to a horizontal position.

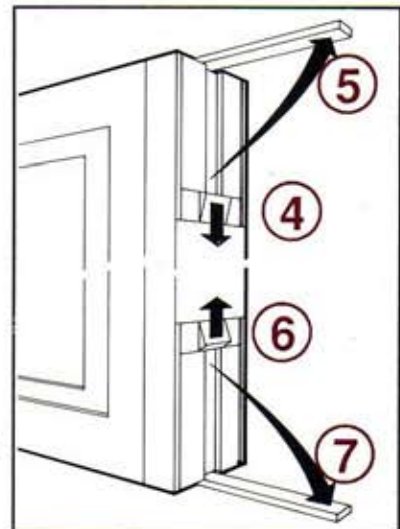

Bristol® Q-IV Swing n' Slide Clean, Operate and Maintain

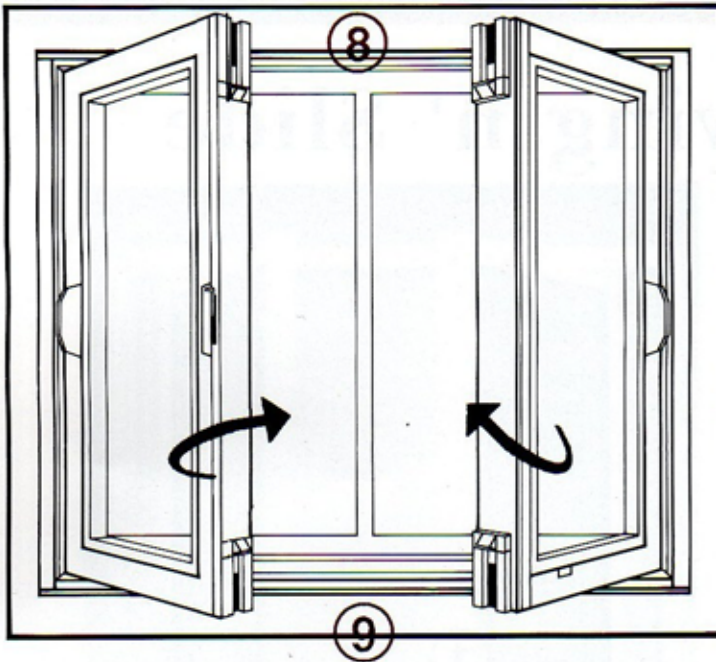

- 4) Grasp sash rail and pull sash in toward yourself. Sash is now completely open for easy cleaning of both sides.
- 5) Repeat step 4 for outer most sash. Slider release lock was disengaged during step 3.

CLEANING:

- 6) The vinyl of your Bristol windows requires minimal routine cleaning. Use a mild detergent for light soil. Heavily soiled areas may require a cleaner with a mild abrasive, (do not use on glass).

SCREEN CLEANING:

- 7) Apply upward pressure by grasping upright screen rails and remove from screen track. Use a soft brush and a mild detergent to clean.

SLIDER ROUTINE MAINTENANCE

Important Note: Periodically clean out both sill tracks for any debris buildup. Inspect weepholes on outside of window to see they are not clogged. If this maintenance is not done, water leakage may occur. In addition, failure to perform this maintenance could void your warranty.

TO CLOSE SASH:

- 8) Close outer-most sash first by grasping and pushing sash back into frame.

Grasp release bar in header ⑧, and press back into a vertical position against sash.

- 9) Grasp release bar in sill, ⑨, and press back into a vertical position against bottom sash.

- 10) To close, slide sash into jamb as far as it will go.

- 11) Repeat steps 8 - 10 for inner most sash.

- 12) Complete closing by putting Q-IV security lock handle in the lower position, the locking position, ⑩.

